

Timber Upper Floors

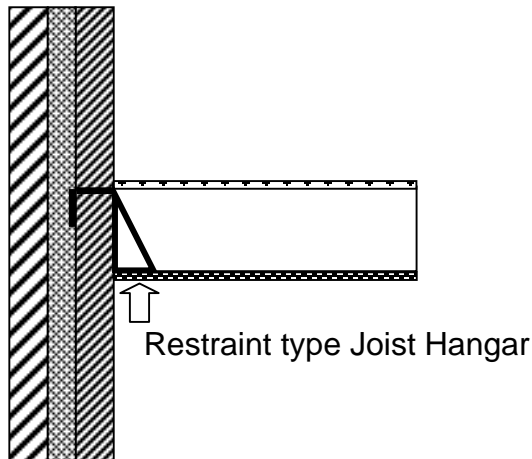

Joists perpendicular to wall

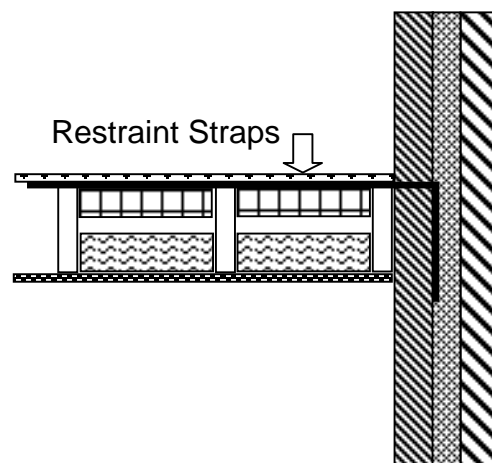

Joists parallel to wall

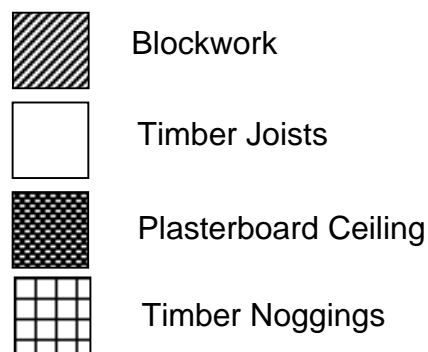
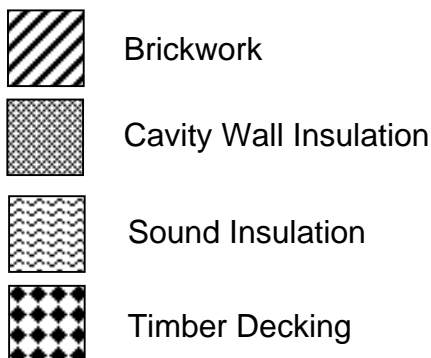

Notes

1. These details assume that timber joists have been sized according to span and loads they are required to carry.
2. The details are primarily intended for domestic buildings.
3. Joists should be supported on restraint type joist hangars where they are supported by external walls.
4. Lateral restraint straps should be provided at 1800mm centres and fixed to noggings and floor joists.
5. Decking should be flooring grade and be at least 15kg/m² for sound resisting purposes.
6. Plasterboard ceiling should be at least 10kg/m² for sound resisting purposes.
7. Sound Insulation should be at least 100mm fibreglass or similar.

For further information contact the Building Regulations Division

Please note that these guidance notes are for advice only and may not cover all situations. It is your responsibility to ensure that they are appropriate for use in your particular circumstance.